

COLLARS

SPUN ALUMINUM STORM COLLARS

PRODUCT INFORMATION

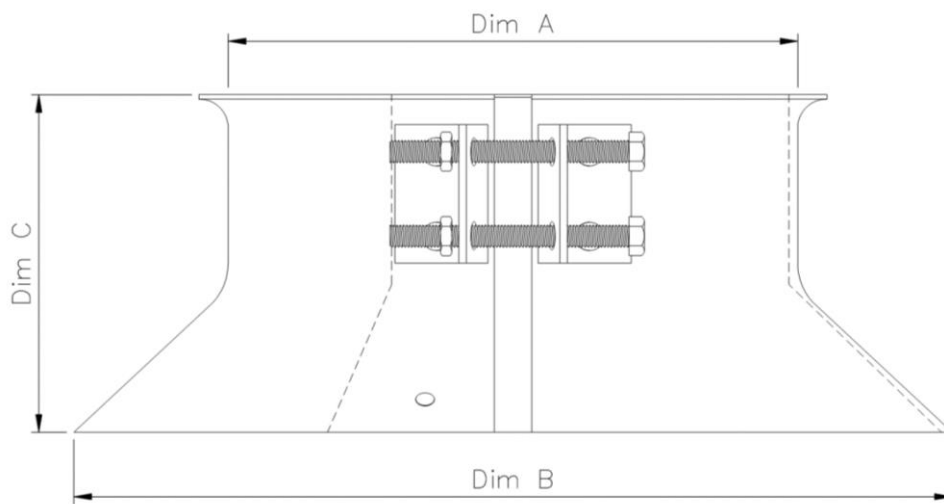

FEATURES:

- Constructed with a 1.8mm Aluminum body (collar) for durability
- Features a 0.8mm Aluminum insert plate riveted onto the collar, allowing for overlapping adjustment
- Includes 2 bolts (M6x65 or M6x130) depending on the collar size for secure fastening
- Provides space for silicone seal at the upper edge where the collar is tightened to the pipe, ensuring a secure fit

APPLICATION:

Storm collars are used to provide an additional layer of protection around vent pipes or chimneys. It is installed above the flashing to prevent water, snow, or debris from entering the roof system at the pipe penetration, ensuring a watertight seal with caulking.

OVERALL DIMENSIONS

SKU	SIZE	DIM. "A" TOP I.D.	DIM. "B" BOTTOM I.D.	DIM. "C" TOTAL HEIGHT
P-11502	2"	1.87"	4.80"	3.39"
P-11504	4"	4"	7.36"	3.74"
P-11506	6"	6"	9.25"	3.54"
P-11508	8"	8"	11.26"	3.54"
P-11510	10"	10"	13.27"	3.54"
P-11512	12"	12"	15.23"	3.54"

There is no equal to **PLATINUM!**

Please note that PLATINUM products may be periodically updated & are subject to change without prior notice.
For additional information, contact PLATINUM ROOFING PRODUCTS
at 1-888-771-4686 or info@platinumroofingproducts.ca